

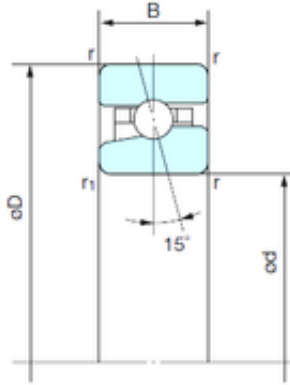

LYC BEARING CORP. OF German LTD.

65 mm x 100 mm x 18 mm NACHI BNH 013
angular contact ball bearings



Bearing No. BNH 013

Size	65x100x18 mm
Bore Diameter	65 mm
Outer Diameter	100 mm
Width	18 mm
d	65 mm
D	100 mm
B	18 mm
C	18 mm
Angle (°)	15 °
r min.	1.1 mm
r1 min.	0.6 mm
Basic dynamic load rating (C)	21,5 kN
Basic static load rating (C0)	23,4 kN
(Grease) Lubrication Speed	15000 r/min

BNH 013 Bearing 2D drawings and 3D CAD models